

BEDIENUNGSANLEITUNG
OPERATING INSTRUCTIONS

A- 0,14-6 mm² /
26-10 AWG

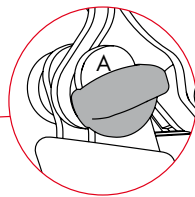

B- 10-16 mm² /
8-6 AWG

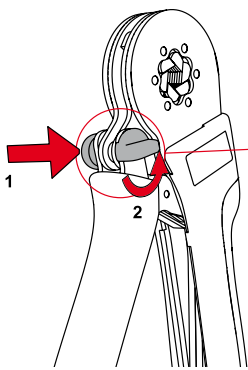
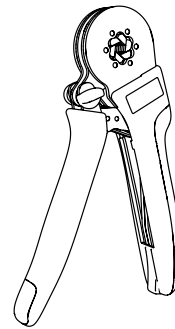
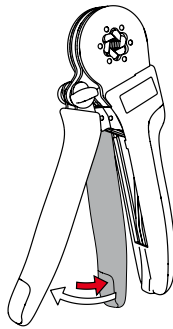
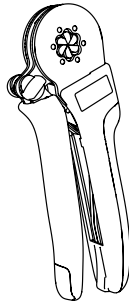
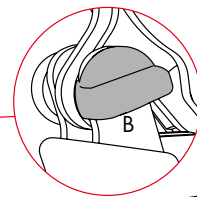
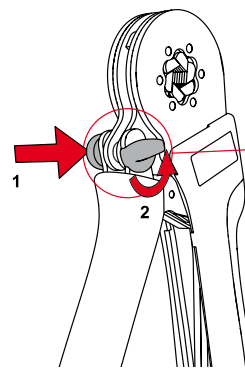
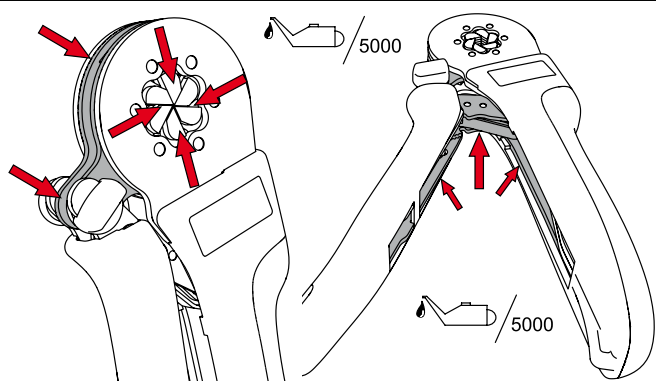
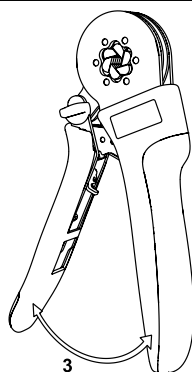
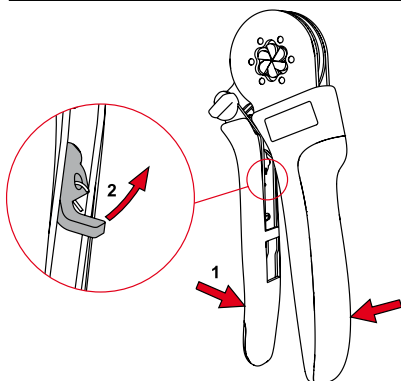
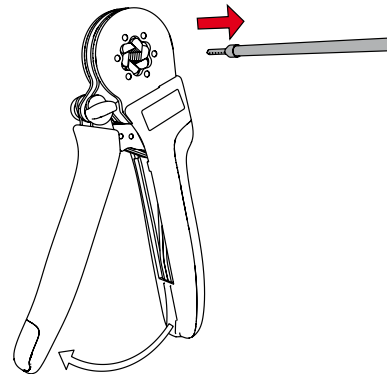
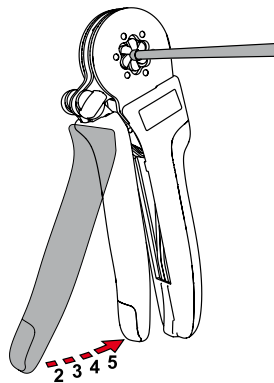
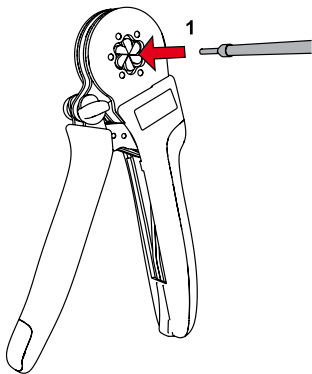

Vorsicht
Caution



Benutzen Sie eine Sicherheitsbrille um Ihre Augen zu schützen
Use safety glasses to avoid eye injury